



Safety shut-off for electric fuel pumps

PIERBURG No. 7.21440.51.0 and 7.21440.53.0

**SERVICE
INFORMATION**

When installing an electric fuel pump instead of a mechanic pump, we recommend for safety reasons always to install a safety shut-off device.

The safety shut-off device shuts down the fuel pump even when the ignition is switched on if the engine does not run. Pierburg provides a safety shut-off device as an installation kit.

Order No.: 4.05288.50.0

The safety shut-off switches off the electric fuel pump if the vehicle's engine stops and the ignition remains on (e.g. engine stalled, accident).

This system also protects the fuel pump from damage that could occur when the engine is at standstill and the ignition is on (risk of overheating).

Scope of delivery

- 1 switch relay with counter connector, mounted connection lines and safety holder with 2A fuse.
- 1 ground cable for fuel pump
- 2 fitting bolts
- 6 different cable connectors
- 1 cable binder
- 1 installation instruction sheet

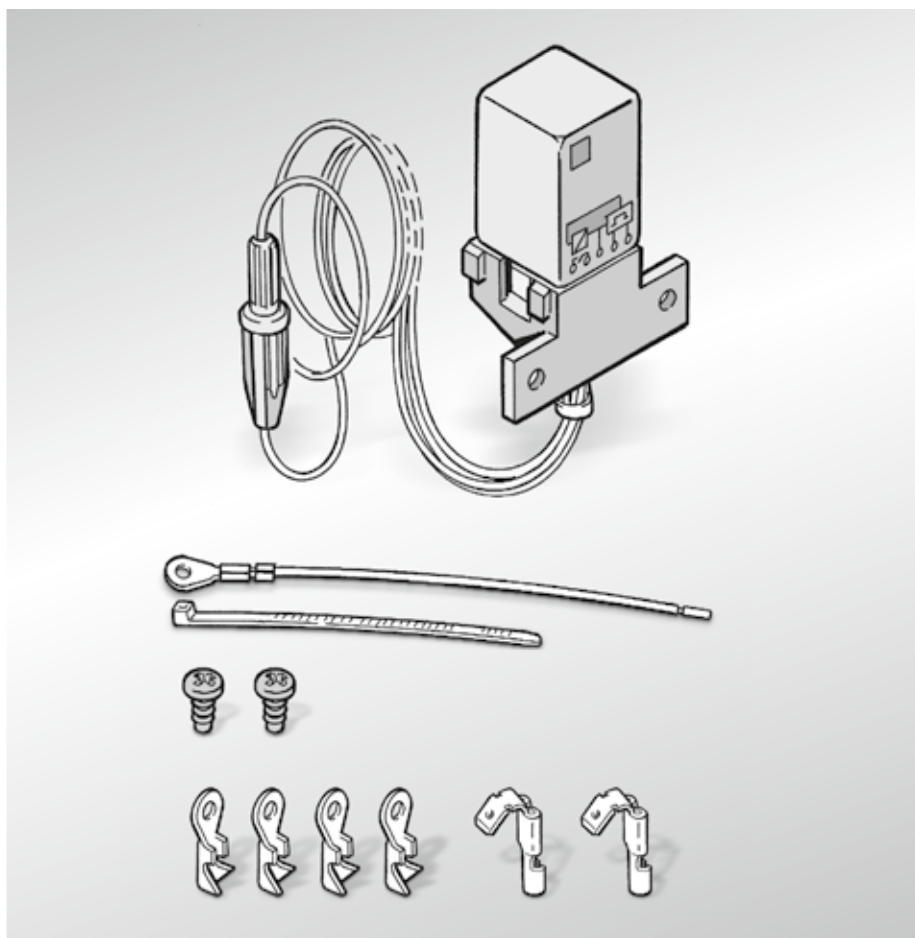

For fitting, connection and function test, see overleaf.

The right of changes and deviating pictures is reserved. Assignment and usage, refer to the each case current catalogues, TecDoc CD respectively systems based on TecDoc.



Installation and connection

Only a qualified person may carry out this work.

- Switch of ignition and disconnect the battery.
- Fit relay with mating connector in a location protected against heat and spray water.
- Connect safety shut-off device as shown in the wiring diagram (see Fig.). Refer to wiring diagram of the vehicle if necessary.
- Route cables so that they do not come into contact with hot parts of the engine.



Pumps with a higher rating must be fused according to their current consumption (up to max. 16A).
See Fuel pump catalogue.

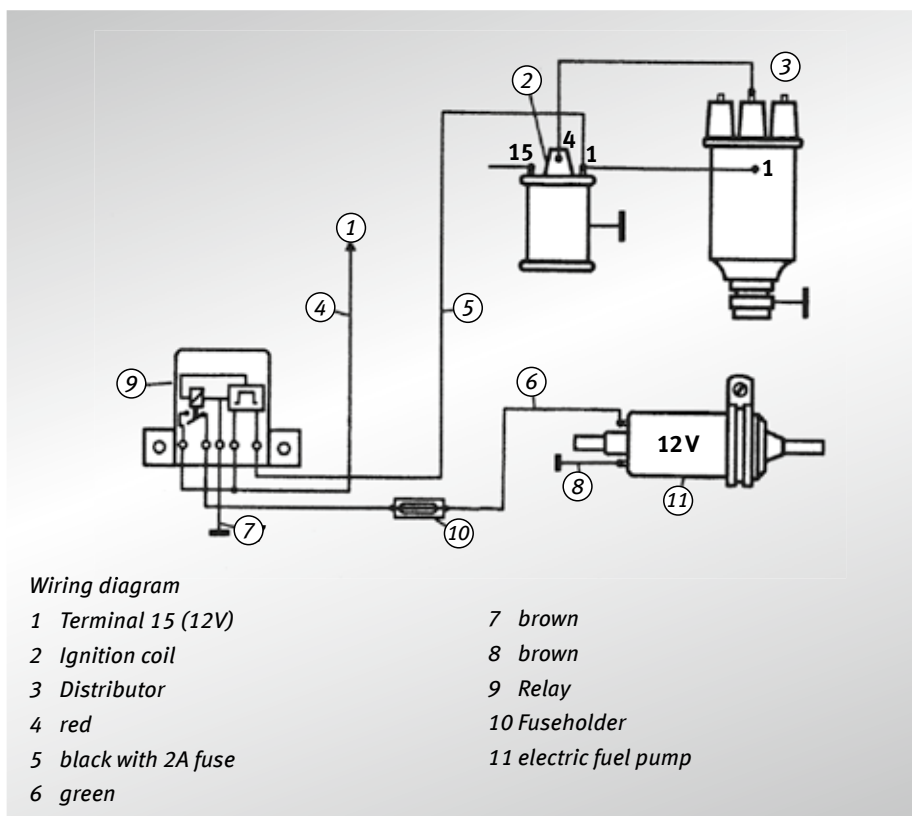

Function test

Precondition: Fuel lines and battery connected.

- Switch on ignition
Depending on the position of the distributor, the fuel pump may run for about 2 seconds.
- Start engine.
The fuel pump must run.
If the engine does not start, the pump will stop after about 2 seconds.
- Switch off the ignition with the engine running.
The fuel pump stops immediately.
- In the event of faults, repeat connection as shown in the wiring diagram.

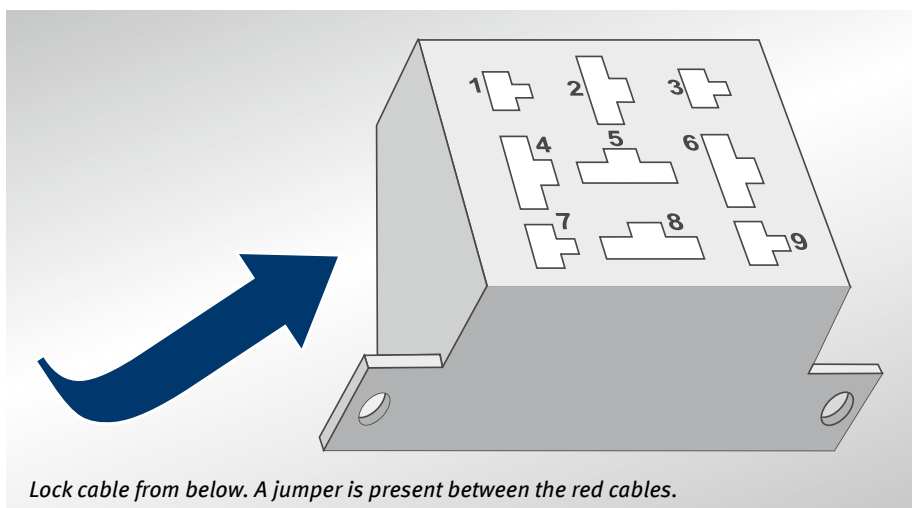

Assignments of relay socket

Socket No.	Cable Colour	Relay terminal No.
2	red	30
4	black	31b
5	brown	31
6	red	15
8	green	87