

A

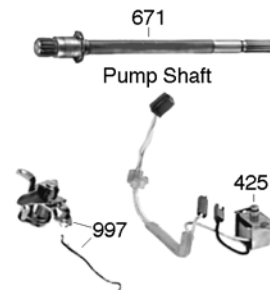

B

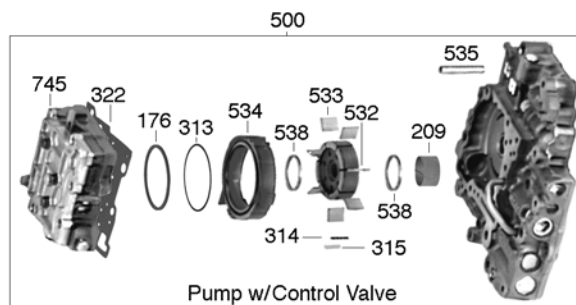
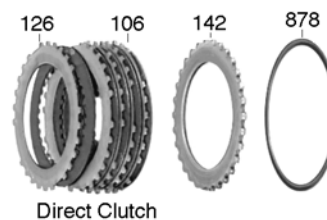
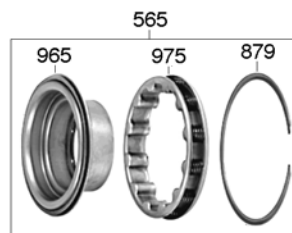
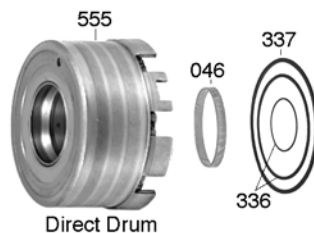

C

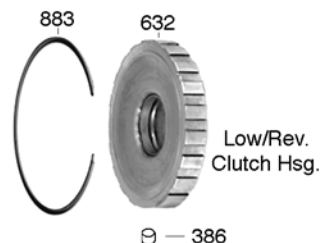
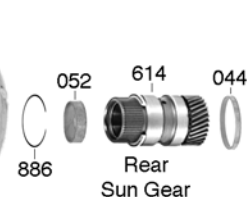

D

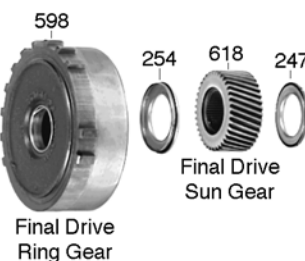
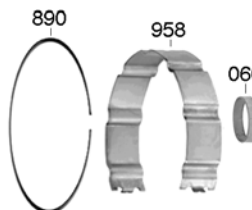

E

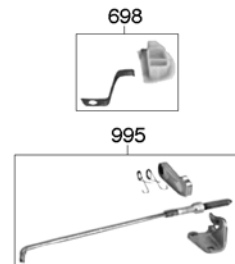
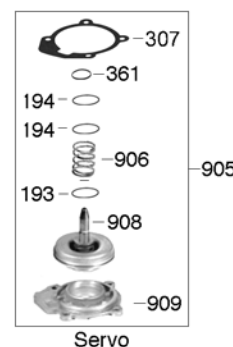
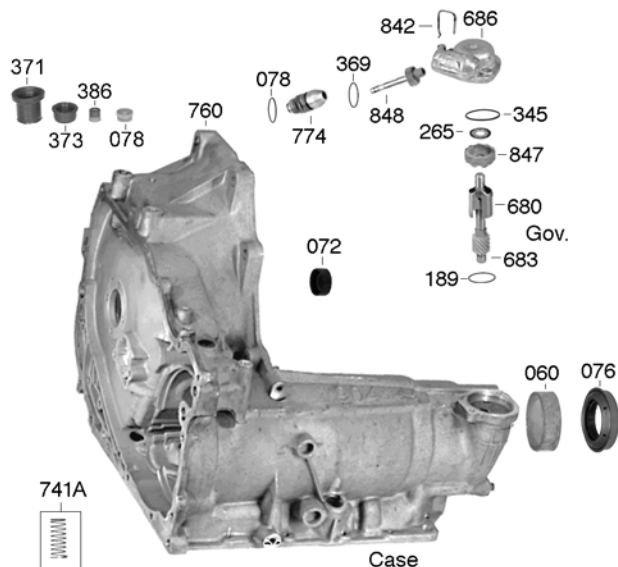

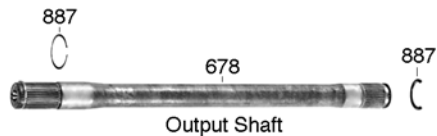

Exploded view of the bottom pan assembly. The components are labeled as follows:

- 010**: A small cylindrical pin or fastener.
- 011**: A larger cylindrical component, possibly a gasket or seal.
- 300**: A large, irregularly shaped gasket or seal with a textured surface.
- 379**: A small circular fastener or screw.
- 765**: The main bottom pan component, a large, irregularly shaped metal tray.
- 839**: A small rectangular component, possibly a gasket or seal.

The assembly is shown in an exploded view, with the components arranged to show their relative positions and how they fit together. The bottom pan (765) is the central component, with the gasket (300) and other parts (010, 011, 379, 839) positioned around it to illustrate the assembly process.

3T40, 125, 125C

Fwd 3 Speed

GM 3T40, 125

| ILL # | Description | Qty | Year | Part # | Reference |
|---|---|-----|----------|--------------|-------------|
| Super Kit With Steels (Deluxe) | | | | Fiber | Cork |
| 008J | ...125, 125C | 1 | .80-E84 | .64008F | .64008 |
| 008J | ...125C | 1 | .L84-Up | .64008BF | .64008B |
| Super Kit Less Steels (Compliance) | | | | Fiber | Cork |
| 007J | ...125, 125C | 1 | .80-E84 | .64007F | .64007 |
| 007J | ...125C | 1 | .L84-Up | .64007BF | .64007B |
| With Steel Kit (Master) | | | | Fiber | Cork |
| 006J | ...125, 125C | 1 | .80-E84 | .64006F | .64006 |
| 006J | ...125C | 1 | .L84-Up | .64006BF | .64006B |
| Less Steel Kit | | | | Fiber | Cork |
| 004J | ...125, 125C | 1 | .80-E84 | .64004F | .64004 |
| 004J | ...125C | 1 | .L84-Up | .64004BF | .64004B |
| Overhaul Kit w/ Rings & Seals | | | | Fiber | Cork |
| 002J | ...125, 125C Combo | 1 | .80-Up | .64002CF | .64002C |
| Gasket & Ring Kit w/o Rings & Seals | | | | Fiber | Cork |
| 000J | ...125, 125C Combo | 1 | .80-Up | .64000CF | .64000C |
| Filters | | | | | |
| 010J | ...125, 125C | 1 | .80-Up | .64010 | .8666665 |
| Filter Kits | | | | | |
| 011J | ...125, 125C | 1 | .80-Up | .64011 | |
| Filters, Miscellaneous | | | | | |
| 014 | ...Screen, Governor Screen (In Case) | 1 | .80-Up | .84014A | .8660770 |
| 015 | ...Valve Body Thimble Filter | 1 | .80-Up | .64015 | |
| 017 | ...TCC Solenoid Filter (125C) | 1 | .80-Up | .64017 | .8664811 |
| Bands | | | | | |
| Prefix Key: B = Borg Warner, A = OEM (Exc BW), N = All Other New, R = Relined | | | | | |
| 022B | ...Flex (Narrow) | 1 | .80-81 | .64022 | .8631030 |
| 022B | ...Flex (Wide) | 1 | .82-93 | .64022A | .8665223 |
| 022B | ...Flex (Wide) (Hi Energy) | 1 | .94-Up | .64022B | .8685538 |
| Bushings | | | | | |
| 030J | ...Bushings Kit | 1 | .80-Up | .64030 | |
| 032E | ...Converter Hub (125) | 1 | .80-81 | .64032 | .8631907 |
| 032E | ...Converter Hub (125C) | 1 | .82-Up | .64032B | .8637905 |
| 036F | ...Stator Support Front | 1 | .80-Up | .54036A | .8628915 |
| 044C | ...Low/ Rev Clutch Housing (Center Support) | 1 | .80-Up | .64044 | .8631905 |
| 044C | ...Rear Planet | 1 | .80-Up | .64044 | .8631905 |
| 045G | ...Driven Sprocket Support | 1 | .80-Up | .64045 | .8631900 |
| 046B | ...Direct Drum (Rear) | 1 | .80-Up | .64046 | .8631901 |
| 046B | ...Direct Drum (Front) | 1 | .80-Up | .64046B | .8631902 |
| 047H | ...Input Shaft | 1 | .80-Up | .64047 | .8631903 |
| 050C | ...Input Gear (Front Ring Gear) | 1 | .80-Up | .64050 | .8631904 |
| 052C | ...Reaction Sun Gear Shaft | 1 | .80-Up | .64052 | .8631906 |
| 060D | ...Final Drive Gear & Case | 2 | .80-Up | .64060 | .8631119 |
| Metal Clad Seals | | | | | |
| 070E | ...Front | 1 | .80-Up | .84070 | .8664812 |
| 072E | ...Manual Lever (.230" Thick) | 1 | .80-83 | .84072 | .8637588 |
| 072E | ...Manual Lever (.350" Thick) | 1 | .84-Up | .84072A | .8644709 |
| 076E | ...Axle (Both Sides) | 2 | .80-Up | .84076 | .8631156 |
| 078 | ...Speed-O Shaft | 1 | .80-Up | .44078X | .1240382 |
| 079 | ...Pump Shaft | 1 | .80-5/84 | .64079 | .8637569 |
| 075 | ...Axle Stabilizer Seal | 1 | .80-Up | .64075 | .N12701A-MC |

| ILL # | Description | Qty | Year | Part # | Reference |
|---|---|------|----------|-----------|-------------------|
| Metal Clad Seals | | | | | |
| 075 |Axle Stabilizer Seal (Teckpak) | 1 | .80-Up | .T84075 |TC-1.375 |
| 090 |Axle Stabilizer, Right Axle (Bushing Type) | 1 | .80-Up | .64090 | |
| 275 |Axle Stabilizer, Both Sides (Bearing Type) (Teckpak) | 1 | .80-Up | .T64275 |75125LRB |
| 209A |Bearing w/ Seal, Pump Shaft | 1 | .6/84-Up | .64209A |8666375 |
| Friction Plates | | | | | |
| 106B | . . .Forward & Direct .080" (32 T) | 8 | .80-E84 | .64106 |8652409 |
| 106B | . . .Forward & Direct .069" (32 T) | 8-10 | .L84-Up | .64106A |8643741 |
| 114I | . . .Low & Reverse .080" (40 T) | 5 | .80-E84 | .64114 |8631080 |
| 114I | . . .Low & Reverse .090" (40 T) | 5 | .L84-Up | .64114A |8666661 |
| Steel Plates | | | | | |
| 126B | . . .Direct .090" (24 T) | 4 | .80-Up | .64126 |8631026 |
| 126B | . . .Direct .100" (24 T) (Oversized) | AR | .80-Up | .64126X | |
| 128H | . . .Forward .076" (26 T) (Flat) | 3-4 | .80-Up | .64128 |8683084 |
| 129H | . . .Forward .050" (26 T) (Waved) | 1-2 | .80-Up | .64129 |8675257 |
| 134I | . . .Low & Reverse .080" (11 T) | 5 | .80-E84 | .64134 |8631079 |
| 134I | . . .Low & Reverse .088" (11 T) | 4 | .L84-Up | .64134A |8652027 |
| 135I | . . .Low & Reverse .078" (11 T) (Waved) | 1-2 | .82-Up | .64135A |8664141 |
| N.I. | . . .Steel Module | 1 | .L84-Up | .64139B | |
| Pressure Plates | | | | | |
|Prefix Key: D = Dealer, No Prefix = New Aftermarket, Q = Quality Inspected | | | | | |
| 142B | . . .Forward & Direct .130" | 1 | .85-Up | .64142D |8664163 |
| 142B | . . .Forward & Direct .150" | 1 | .85-Up | .64142C |24200479 |
| 142B | . . .Forward & Direct .170" | 1 | .85-Up | .64142B | |
| 142B | . . .Forward & Direct .182" | 1 | .80-Up | .64142AB | |
| 142B | . . .Forward & Direct .193" | 1 | .80-84 | .64142 |8658146 |
| 142B | . . .Forward & Direct .193" | 1-2 | .85-Up | .64142A |8652562 |
| 142B | . . .Forward & Direct .210" | 1 | .80-Up | .64142AC | |
| 154I | . . .Low & Reverse | 1 | .80-Up | .64154 |8631091 |
| Valve Body Recalibration Kits | | | | | |
| 165J | . . .Shift Kit®, 125/125C, Corrects/ Prevents 3-2 Clunk | 1 | .80-Up | .T64165 |SK® 125 |
| 165J | . . .Valve Body Kit | 1 | .80-Up | .S64165 |K-125 |
| Sealing Rings | | | | | |
| 175J | . . .Ring Kit, (Metal) | 1 | .80-Up | .64175 | |
| 175J | . . .Ring Kit, (Teflon) | 1 | .80-Up | .64175T | |
| 176A | . . .Pump Slide to Body | 1 | .80-Up | .64176T |8631417 |
| 538A | . . .Ring, Pump Rotor to Vanes | 2 | .80-Up | .64538 |8631279 |
| 177H | . . .Input Shaft | 2 | .80-Up | .64177T | |
| 178F | . . .Turbine Shaft (Front) (Scarf Cut) | 1 | .80-81 | .64178T |8631211 |
| 178F | . . .Turbine Shaft (Front) (Solid) | 1 | .82-Up | .64178AT |8637170 |
| 178F | . . .Turbine Shaft (Rear) (Scarf Cut) | 2 | .80-81 | .64178T |8631211 |
| 178F | . . .Turbine Shaft (Rear) (Solid) | 2 | .82-Up | .64178BT |8643058 |
| 189E | . . .Governor Pin | 1 | .80-Up | .54189BT |8632588 |
| 192G | . . .1-2 Accumulator Piston | 1 | .80-87 | .64192T | |
| 352 | . . .Lathe Cut Seal, 1-2 Accumulator Piston (Rubber) | 1 | .88-Up | .64352 |8665807 |
| 193E | . . .Band Apply Pin | 1 | .80-Up | .64193T |8631105 |
| 194E | . . .Intermediate Servo 1.260"OD (Inner) | 1 | .80-81 | .64194T |8631468 |
| 194E | . . .Intermediate Servo 1.500"OD (Inner) | 1 | .80-Up | .64194BT |8631469 |
| 194E | . . .Intermediate Servo 1.675"OD (Inner) | 1 | .80-Up | .64194AT |8631470 |
| 194E | . . .Intermediate Servo Piston (Outer) | 1 | .80-85 | .54194ADT |8631473 |
| Thrust Washers | | | | | |
| 200J | . . .Washer Kit, (No Bearings or Selective Washers) | 1 | .80-Up | .64200 |8665957 |
| 226B | . . .Direct Drum to Support | 1 | .80-Up | .64226 |8631029 |
| 232C | . . .Forward Drum to Hub 1.220" ID (Plastic) | 1 | .80-87 | .64232 |8652759 |

3T40, 125, 125C

Fwd 3 Speed

GM 3T40, 125

| ILL # | Description | Qty | Year | Part # | Reference |
|------------------------------|--|-----|---------|----------|-----------|
| Thrust Washers | | | | | |
| 232C | ...Forward Drum to Hub 1.270" ID (Brass) | 1 | 87-Up | .64232A | .8664762 |
| 235C | ...Front Planet to Hub | 1 | 80-Up | .64235 | .8631063 |
| 238C | ...Front Planet to Sun Gear | 1 | 80-Up | .64238 | .8631062 |
| 244I | ...Sprag to Rear Planet | 1 | 80-Up | .64244 | .8631227 |
| 251D | ...Rear Planet to Rear Ring Gear | 1 | 80-Up | .54251A | .8628188 |
| 265E | ...Governor to Cover | 1 | 80-Up | .64265 | .8631766 |
| 278F | ...Drive Sprocket to Cover (1 7/8"OD) | 1 | 80-85 | .64278 | .8652868 |
| 278F | ...Drive Sprocket to Cover (Can Use 64278) | 1 | 86-Up | .64278A | .8652868 |
| 279F | ...Drive Sprocket to Support | 1 | 80-85 | .64279 | .8652841 |
| 279F | ...Drive Sprocket to Support | 1 | 86-Up | .64279A | .8652841 |
| 281G | ...Driven Sprocket Rear | 1 | 80-81 | .64281 | .8631981 |
| 281G | ...Driven Sprocket Rear | 1 | 82-Up | .64281A | .8637227 |
| N.I. | ...Repair Kit, Front Planet (4 Brass, 8 Steel Round, & 4 Batwing Washers) | 1 | 80-Up | .64204A | .K75904 |
| N.I. | ...Repair Kit, Front Planet (8 Brass Round Washers) | 1 | 80-Up | .64204AA | |
| N.I. | ...Repair Kit, Rear Planet (16 Steel Washers) (Small) (.850" OD, .440" ID) | 1 | 80-Up | .64204B | .K75905 |
| N.I. | ...Repair Kit, Final Drive Planet (8 Brass & 8 Steel Washers) (Small) (125) | 1 | 80-Up | .64204C | .8665957 |
| N.I. | ...Repair Kit, Final Drive Planet (8 Brass & 8 Steel Washers) (Large) (125C) | 1 | 80-Up | .64204D | .K75906A |
| Bearings | | | | | |
| 201J | ...Bearing Kit | 1 | 80-Up | .64201A | |
| 209A | ...Pump Shaft w/o Seal | 1 | 80-5/84 | .64209 | .8631277 |
| 209A | ...Pump Shaft w/ Seal | 1 | 6/84-Up | .64209A | .8666375 |
| 244I | ...Sprag to Rear Planet (Late) | 1 | 80-Up | .64244A | |
| 247D | ...Rear Sun Gear & Final Drive Sun Gear (Rear) | 2 | 80-Up | .54247A | .8628962 |
| 254D | ...Final Drive Sun Gear (Front) | 1 | 80-Up | .64254 | .8631116 |
| 265E | ...Governor to Cover | 1 | 80-Up | .64265A | .8635490 |
| 280G | ...Case Cover to Driven Sprocket | 1 | 80-Up | .44211C | .9436851 |
| 292J | ...Differential to Case | 1 | 80-Up | .64292 | .8631362 |
| 295F | ...Inside Converter Reactor | 1 | 80-Up | .64295 | .8631186 |
| 298G | ...Driven Sprocket Support | 1 | 80-Up | .64298 | .8631190 |
| 090 | ...Axle Stabilizer, Right Axle (Bushing Type) | 1 | 80-Up | .64090 | |
| 275 | ...Axle Stabilizer, Both Sides Bearing Type (OEM) (Teckpak) | 1 | 80-Up | .T64275 | .75125LRB |
| 275 | ...Repair Sleeve, For 64275 | 1 | 80-Up | .64275S | |
| Spacers & Shims | | | | | |
| 210 | ...Spacer, Pump Shaft | 1 | 80-Up | .64210 | |
| 243I | ...Spacer, Low/ Reverse Clutch Housing to Inner Race 1.00mm-1.10mm | 1 | 80-Up | .64243 | .8631241 |
| 243I | ...Spacer, Low/ Reverse Clutch Housing to Inner Race 1.42mm-1.52mm | 1 | 80-Up | .64243A | .8631242 |
| 243I | ...Spacer, Low/ Reverse Clutch Housing to Inner Race 1.84mm-1.94mm | 1 | 80-Up | .64243B | .8631243 |
| 243I | ...Spacer, Low/ Reverse Clutch Housing to Inner Race 2.26mm-2.36mm | 1 | 80-Up | .64243C | .8631244 |
| 243I | ...Spacer, Low/ Reverse Clutch Housing to Inner Race 2.68mm-2.78mm | 1 | 80-Up | .64243D | .8631245 |
| 243I | ...Spacer, Low/ Reverse Clutch Housing to Inner Race 3.10mm-3.20mm | 1 | 80-Up | .64243E | .8631246 |
| 293J | ...Spacer, Differential to Case 1.45mm (#0) | 1 | 80-Up | .64293 | .8631420 |
| 293J | ...Spacer, Differential to Case 1.55mm (#1) | 1 | 80-Up | .64293A | .8631421 |
| 293J | ...Spacer, Differential to Case 1.65mm (#2) | 1 | 80-Up | .64293B | .8631422 |
| 293J | ...Spacer, Differential to Case 1.75mm (#3) | 1 | 80-Up | .64293C | .8631423 |
| 293J | ...Spacer, Differential to Case 1.85mm (#4) | 1 | 80-Up | .64293D | .8631424 |
| 293J | ...Spacer, Differential to Case 1.95mm (#5) | 1 | 80-Up | .64293E | .8631425 |
| 293J | ...Spacer, Differential to Case 2.05mm (#6) | 1 | 80-Up | .64293F | .8631426 |
| 293J | ...Spacer, Differential to Case 2.15mm (#7) | 1 | 80-Up | .64293G | .8631427 |
| 293J | ...Spacer, Differential to Case 2.25mm (#8) | 1 | 80-Up | .64293H | .8631428 |
| 293J | ...Spacer, Differential to Case 2.35mm (#9) | 1 | 80-Up | .64293J | .8631429 |
| 293J | ...Shim, Adjusts Rear End Play .005" | 1 | 80-Up | .64293S | |
| Gaskets & O-Rings | | | | | |
| 300J | ...Gasket, Bottom Pan (Cork) | 1 | 80-Up | .64300 | .8631338 |
| 300J | ...Gasket, Bottom Pan (Fiber) | 1 | 80-Up | .64300F | .8631338 |
| 300J | ...Gasket, Bottom Pan 3T40A (AwD) (OEM) | 1 | 80-Up | .D64300B | .8665115 |
| 300J | ...Gasket, Bottom Pan 3T40A (AwD) (Fiber) | 1 | 80-Up | .64300BF | .8665115 |
| 301A | ...Gasket, Side Pan (Valve Body Cover) (Cork) | 1 | 80-Up | .64301 | .8643573 |

| ILL # | Description | Qty | Year | Part # | Reference |
|------------------------------|---|-----|---------|----------|--------------|
| Gaskets & O-Rings | | | | | |
| 301A | .Gasket, Side Pan (Valve Body Cover) (Fiber) | 1 | .80-Up | .64301F | .8643573 |
| 307E | .Gasket, Intermediate Servo Cover | 1 | .80-Up | .64307 | .8631698 |
| 308G | .Gasket, Case Cover to Case (Small Center) | 1 | .80-Up | .64308 | .8643618 |
| 313A | .O-Ring, Pump Slide | 1 | .80-Up | .64313 | .8631504 |
| 314A | .Seal, Pump Slide (Rubber) | 1 | .80-Up | .54314B | .8631283 |
| 315A | .Seal, Pump Slide (Teflon) | 1 | .80-Up | .54315B | .8631877 |
| 320A | .Gasket, Valve Body (Upper & Lower) | 2 | .80-Up | .64320 | .8652065 |
| 322A | .Gasket, Auxiliary Valve Body | 1 | .82-E84 | .64322A | .8653947 |
| 322A | .Gasket, Auxiliary Valve Body | 1 | .L84-Up | .64322 | .8643863 |
| 322A | .Gasket, Auxiliary Valve Body (Orange Stripe) | 1 | .87-Up | .64322B | .8666380 |
| 322A | .Gasket, Auxiliary Valve Body (Blue Stripe) | 1 | .88-Up | .64322C | .8666381 |
| 324F | .Gasket, Case Cover to Case (Large Outer) | 1 | .80-Up | .64324 | .8660775 |
| 334H | .Lip Seal, Forward Clutch (Inner) | 1 | .80-86 | .64334 | .8652460 |
| 334H | .Lip Seal, Forward Clutch (Inner) | 1 | .87-Up | .64334A | |
| 335H | .Lip Seal, Forward Clutch (Outer) | 1 | .80-86 | .64335 | .8631013 |
| 335H | .Lip Seal, Forward Clutch (Outer) | 1 | .87-Up | .64335A | |
| 336B | .Lip Seal, Direct Clutch (Inner) | 1 | .80-Up | .64336 | .8631403 |
| 336B | .Lip Seal, Direct Clutch (Center) | 1 | .80-Up | .64336C | .8631014 |
| 337B | .Lip Seal, Direct Clutch (Outer) (Long Lip) | 1 | .80-Up | .64337B | .8631592 |
| 338I | .Lip Seal, Low/ Reverse Clutch (Inner) | 1 | .80-86 | .64338 | .8631074 |
| 338I | .Lip Seal, Low/ Reverse Clutch (Inner) | 1 | .87-Up | .64338A | |
| 339I | .Lip Seal, Low/ Reverse Clutch (Outer) | 1 | .80-Up | .64339 | .8631547 |
| 345E | .Lathe Cut Seal, Governor Cover | 1 | .80-Up | .84345 | .8660545 |
| 352 | .Lathe Cut Seal, 1-2 Accumulator Piston | 1 | .88-Up | .64352 | .8665807 |
| 356 | .Spring, Pump Slide | 1 | .80-Up | .64356 | .8631717 |
| 361E | .Lip Seal, Intermediate Servo .856" ID (Inner) | 1 | .85-Up | .64361AB | .8652445 |
| 361E | .Lip Seal, Intermediate Servo 1.089" ID (Inner) | 1 | .85-Up | .64361AC | .8652444 |
| 361E | .Lip Seal, Intermediate Servo 1.261" ID (Inner) | 1 | .85-Up | .64361AD | .8652443 |
| 361E | .Lip Seal, Intermediate Servo (Outer) | 1 | .86-Up | .64361A | .8652446 |
| 361E | .Lip Seal Set, Intermediate Servo (w/ All Sizes) | 1 | .80-Up | .64361K | |
| 368 | .O-Ring, Case Connector | 1 | .80-Up | .44369B | .6264903 |
| 368 | .O-Ring, Speedo Sleeve | 1 | .80-Up | .64368A | |
| 369 | .O-Ring, Speed-O Driven Gear Sleeve | 1 | .80-85 | .64369 | |
| 369 | .Seal Kit, Speed-O Sensor (Gasket & 2 O-Rings) | 1 | .80-Up | .64369K | |
| 371 | .O-Ring, Filler Tube | 1 | .80-Up | .44371A | .6264902 |
| 371 | .Boot, Filler Tube | 1 | .80-Up | .44371B | .1259475 |
| 373 | .O-Ring, Detent Cable | 1 | .80-Up | .54373A | .358424 |
| 373 | .Boot, Detent Cable | 1 | .80-Up | .54373B | .25518260 |
| 375 | .O-Ring, Right Axle Stabilizer O-Ring (OEM Type) | 1 | .80-Up | .64375 | |
| 376 | .O-Ring, TCC Solenoid (Black Poly) | 1 | .80-Up | .64376 | |
| 379J | .Filter Seal (Late) | 1 | .80-Up | .64379 | .8652898 |
| 380F | .O-Ring, Turbine Shaft O-Ring | 1 | .80-Up | .64380 | .8677453 |
| 382E | .O-Ring, Reverse Oil Pipe O-Ring to Case | 1 | .80-Up | .64382 | .8631331 |
| 382E | .Washer, Reverse Oil Pipe Washer to Case O-Ring | 1 | .80-Up | .64382W | .8631944 |
| 386C | .Seal/Cup Plug, Low/ Reverse Clutch Housing | 1 | .80-Up | .54386A | .8682481 |
| 386C | .Seal/Cup Plug, Low/ Reverse Clutch Housing (Updated, Long) | 1 | .80-Up | .64386B | .8664492 |
| 386C | .Seal Kit, Low/ Rev Clutch Oil Pipe (O-Ring, Washer, & Seal/Cup Plug) | 1 | .80-Up | .64386K | .8631944 |
| N.I. | .External Seal Kit | 1 | .80-Up | .64390 | |
| Technical Manuals | | | | | |
| 400J | .Tech Manual | 1 | .80-Up | .64400 | .83-125TM |
| 400J | .Tech Manual, 125C Update | 1 | .87-Up | .64400H | .83-125TM-U1 |
| Electrical Components | | | | | |
| 411 | .Switch, 2nd Clutch Pressure (3 Prong) | 1 | .87-Up | .64411A | .8664388 |
| 412 | .Switch, 3rd Clutch Pressure (2 Button) | 1 | .82-Up | .64412 | .8643710 |
| 412 | .Switch, 3rd Clutch Pressure (1 Prong) 4.3L | 1 | .82-Up | .54411B | .8683502 |
| 412 | .Switch, 3rd Clutch Pressure (1 Button Prong) | 1 | .89-Up | .64412B | .8665355 |
| 416 | .Switch, 3rd Clutch Pressure (1 Prong, w/ Bracket & 7/8" Long Rod) | 1 | .89-Up | .64412E | .8666603 |
| 416 | .Switch, Governor Pressure (42-46 PSI) (2 Blade) | 1 | .80-Up | .64416AA | .8643367 |
| 416 | .Switch, Governor Pressure (46-50 PSI) (2 Blade) | 1 | .80-Up | .64416B | .8643369 |

3T40, 125, 125C

Fwd 3 Speed

GM 3T40, 125

| ILL # | Description | Qty | Year | Part # | Reference |
|--|---|-----|----------|-----------|-----------|
| Electrical Components | | | | | |
| 416 | Switch, Governor Pressure (50-54 PSI) | 1 | 80-Up | .64416D | .8643362 |
| 425A | Solenoid, (TCC) (Universal) | 1 | 80-Up | .84425 | .8633945 |
| 425A | Solenoid, TCC (1 Wire to Connector) (1 Spade) | 1 | 80-Up | .64425A | .8689903 |
| 425A | Solenoid, TCC (2 Wire to Connector) (2 Spades) | 1 | 80-Up | .64425B | .8689901 |
| 425A | Solenoid, TCC (3 Wire to Connector) (4 Spades) | 1 | 80-Up | .64425H | .8652376 |
| 425A | Solenoid, TCC (3 Wire to Connector) (2 Spades) | 1 | 80-Up | .64425E | .8652377 |
| 425A | Solenoid, TCC (4 Wire to Round Connector) (4 Spades) | 1 | 80-Up | .64425C | .8665016 |
| 425A | Solenoid, TCC (4 Wire to Square Connector) (4 Spades) (w/ Channel Retainer) | 1 | 80-Up | .64425F | .8665356 |
| 425A | Solenoid, TCC (4 Wire to Square Connector) (4 Spades) (No Channel Retainer) | 1 | 80-Up | .64425D | .8689902 |
| 441 | Element Plate Kit, Thermostatic Element (Goes on Channel Plate) | 1 | 80-Up | .64441 | .8631956 |
| 444 | Connector, Case (2 Prong) | 1 | 80-Up | .74444 | .12300205 |
| 444 | Connector, Case (3 Prong) | 1 | 80-Up | .74444A | .8634383 |
| 444 | Connector, Case (4 Prong Round Natural Plastic) | 1 | 80-Up | .64444 | .24202567 |
| 444 | Connector, Case (4 Prong Square) | 1 | 80-Up | .84444 | .8662395 |
| 445 | Wire Harness, External (4 Wire) | 1 | 80-Up | .64445 | .24202567 |
| 447 | Wire Harness, 2 Wire (Blue) (Shift Rite) | 1 | 80-Up | .64447B | |
| 447 | Wire Harness, 3 Wire (White) (Shift Rite) | 1 | 80-Up | .64447C | |
| 447 | Wire Harness, 4 Wire (Black) (Shift Rite) | 1 | 80-Up | .64447A | |
| 445 | Repair Kit, External Wire Harness (Square 4 Prong) (Plugs into Connector) | 1 | 80-Up | .64445K | |
| N.I. | Lock-up Delay Module For Vehicle w/ Speed Sensor | 1 | 80-Up | .LU1 | .LU1 |
| N.I. | LU1 Sensor GM Front Wheel Drive w/ Extension Cable | 1 | 80-Up | .LU1-4226 | .LU1-4226 |
| Miscellaneous Components | | | | | |
| 480 | Capsule w/ Check Ball, Forward Drum | 1 | 80-Up | .64480 | .8633748 |
| 480 | Capsule w/ Check Ball, Various GM Drum/Stator .260" Diameter (Copper) | 1 | 80-Up | .54480C | |
| 482 | Capsule w/ Check Ball, Direct Drum | 1 | 80-Up | .74482P | .8628732 |
| 483 | Cup Plug, 3RD Clutch Oil Passage .250" Diameter | 1 | 80-Up | .64483D | .8611710 |
| 483 | Cup Plug, Park Pawl Shaft | 1 | 80-Up | .64483C | .8631016 |
| 483 | Cup Plug, Valve Body Orifice (Between Solenoid & Auxiliary Valve Body) | 1 | 80-Up | .64483A | .8624826 |
| 484 | Cup Plug Orifice, Servo Air Bleed (w/ .004" Orifice) .250" Diameter | 1 | 80-Up | .64484A | .8628864 |
| 487 | GM E-Clips | 1 | 80-Up | .M463EA | .9431762 |
| Pumps | | | | | |
| Prefix Key: AR = Reman, D = Dealer, A = New Aftermarket, Q = Quality Inspected, U = Used | | | | | |
| 500A | Pump, w/ Valve Body (w/o Tube) | 1 | 80-81 | .64500 | |
| 500A | Pump, w/ Valve Body (w/ Tube) | 1 | 80-81 | .64500A | |
| 500A | Pump, w/ Valve Body | 1 | 82-84 | .64500B | |
| 500A | Pump, w/ Valve Body (1 Solenoid & 1 Switch) (Square 2 Wire Connector) | 1 | 85-87 | .64500C | |
| 500A | Pump, w/ Valve Body (1 Solenoid & 2 Switches) (Round 4 Wire Connector) | 1 | 87-Up | .64500D | |
| 500A | Pump, w/ Valve Body (1 Solenoid & 2 Switches) (Square 3 Wire Connector) | 1 | 87-Up | .64500DB | |
| 500A | Pump, w/ Valve Body (1 Solenoid & 2 Switches) (Square 4 Wire Connector) | 1 | 87-Up | .64500DA | .24200514 |
| (D, DA, DB Will Interchange If The Original Solenoid Wiring is Used) | | | | | |
| 209A | Bearing, Pump Shaft w/o Seal | 1 | 80-5/84 | .64209 | .8631277 |
| 209A | Bearing w/ Seal, Pump Shaft | 1 | .6/84-Up | .64209A | .8666375 |
| 314A | Seal, Pump Slide (Rubber) | 1 | 80-Up | .54314B | .8631283 |
| 315A | Seal, Pump Slide (Teflon) | 1 | 80-Up | .54315B | .8631877 |
| 541 | Sleeve, Pump Cover Sleeve (Tin) | 1 | 80-Up | .64541 | .8631288 |
| 529F | Converter Reactor (Stator Support) | 1 | 80-81 | .64529 | .8637415 |
| 529F | Converter Reactor (Stator Support) | 1 | 82-Up | .64529A | .24212471 |
| 531 | Rotor Kit, 20 Spline Rotor (.708" Thick) | 1 | 80-Up | .64531 | |
| 531 | Rotor Kit, 15 Spline Rotor (.708" Thick) | 1 | 80-Up | .64531B | |
| 531 | Rotor Kits Conversion, (Converts 20 Spline to 15 Spline Rotor) | 1 | 80-Up | .64531BK | |
| (Contains; Conversion Pump Shaft, 15 Spline Rotor, & Vanes) | | | | | |
| 532A | Rotor, 20 Spline (.708" Thick) | 1 | 80-Up | .64532 | .8631497 |
| 532A | Rotor, 15 Spline (.708" Thick) | 1 | 80-Up | .64532A | .8652247 |
| 533A | Vane | 7 | 80-Up | .64533 | .8631280 |
| 533A | Vane, Bottle of 50 | 1 | 80-Up | .64533-50 | |
| 533A | Vane & Ring Kit | 1 | 80-Up | .64533K | |
| 534A | Pump Slide | 1 | 80-Up | .64534 | .8631802 |
| 534A | Slide & Rotor Kit, (.7072") | 1 | 80-Up | .64534AK | .8665951 |
| 534A | Slide & Rotor Kit, (.7076") | 1 | 80-Up | .64534BK | .8665952 |

| ILL # | Description | Qty | Year | Part # | Reference |
|---|--|-----|---------|----------|-----------|
| Pumps | | | | | |
| 534A | ..Slide & Rotor Kit, (.7080") | 1 | .80-Up | .64534CK | .8665953 |
| 534A | ..Slide & Rotor Kit, (.7084") | 1 | .80-Up | .64534DK | .8665954 |
| 534A | ..Slide & Rotor Kit, (.7088") | 1 | .80-Up | .64534EK | .8665955 |
| 535A | ..Pivot Pin, Pump Slide | 1 | .80-Up | .64535 | .8628273 |
| 536 | ..Spring, Pump Slide | 1 | .80-Up | .64536 | .8631717 |
| 538A | ..Ring, Pump Rotor to Vanes | 2 | .80-Up | .64538 | .8631279 |
| 547 | ..Apply Ring, Forward Clutch | 1 | .80-Up | .64547 | .8631376 |
| 549 | ..Apply Ring, Reverse Clutch | 1 | .80-Up | .64549 | .8643490 |
| Drums | | | | | |
|Prefix Key: AR = Reman, D = Dealer, A = New Aftermarket, Q = Quality Inspected, U = Used | | | | | |
| 554H | ..Forward, w/ Check Ball | 1 | .80-81 | .64554 | .8653977 |
| 554H | ..Forward, w/o Check Ball | 1 | .80-84 | .64554A | .8664982 |
| 554H | ..Forward, (Uses 1.220" ID Washer # 232) | 1 | .85-86 | .64554B | |
| 554H | ..Forward, (Uses 1.270" ID Washer # 232) | 1 | .87-Up | .64554C | .9664982 |
| 555B | ..Direct (2 1/16" Band Surface) | 1 | .80-81 | .64555 | |
| 555B | ..Direct (2 1/4" Band Surface) | 1 | .80-84 | .64555A | .8653983 |
| 555B | ..Direct (2 1/4" Band Surface) (Can Use 64555A) | 1 | .85-Up | .64555B | .8653971 |
| 564H | ..Piston Kit, Forward Clutch | 1 | .80-Up | .64564 | |
| 565B | ..Piston Kit, Direct Clutch | 1 | .80-Up | .64565 | |
| 567I | ..Piston Kit, Low/ Reverse Clutch | 1 | .80-Up | .64567 | .8653916 |
| Planets | | | | | |
|Prefix Key: AR = Reman, D = Dealer, A = New Aftermarket, Q = Quality Inspected, U = Used | | | | | |
| 582C | ..Front (Input) | 1 | .80-Up | .64582 | .8686142 |
| 584D | ..Rear (Reaction) | 1 | .80-Up | .64584 | .8683633 |
| 592C | ..Ring Gear, Input Internal (Front) | 1 | .80-Up | .64592 | .8631049 |
| 594D | ..Ring Gear, Reaction Internal (Rear) | 1 | .80-Up | .64594 | .8652236 |
| 598D | ..Ring Gear, Differential Internal | 1 | .80-Up | .64598 | .8652701 |
| Sun Gears, Shells & Supports | | | | | |
|Prefix Key: AR = Reman, D = Dealer, A = New Aftermarket, Q = Quality Inspected, U = Used | | | | | |
| 612C | ..Sun Gear, Input (Front Planet) | 1 | .80-Up | .64612 | .8652644 |
| 614C | ..Sun Gear, Reaction (Rear Planet) | 1 | .80-Up | .64614 | .8631845 |
| 618D | ..Sun Gear, Final Drive 30 Teeth | 1 | .80-Up | .84618B | .24209169 |
| 618D | ..Sun Gear, Final Drive 34 Teeth | 1 | .80-Up | .84618A | .8676105 |
| 618D | ..Sun Gear, Final Drive 38 Teeth | 1 | .80-Up | .84618D | .24209185 |
| 622C | ..Shell, Input | 1 | .80-81 | .64622 | |
| 622C | ..Shell, Input (w/ Scoops & Roll Pins) | 1 | .82-Up | .64622A | .8652435 |
| 622C | ..Shell, Input (w/ Scoops Only) | 1 | .82-86 | .64622B | |
| 632C | ..Center Support, Low/ Reverse Clutch Housing | 1 | .80-81 | .64632 | |
| 632C | ..Center Support, Low/ Reverse Clutch Housing | 1 | .82-84 | .64632A | .8653915 |
| 632C | ..Center Support, Low/ Reverse Clutch Housing | 1 | .85-Up | .64632B | .8666656 |
| Sprags | | | | | |
| 652I | ..Sprag, Low Roller Clutch | 1 | .80-Up | .64652 | .8652403 |
| 662I | ..Inner Race, Low Roller Clutch | 1 | .80-Up | .64662 | .8631093 |
| Shafts | | | | | |
|Prefix Key: AR = Reman, D = Dealer, A = New Aftermarket, Q = Quality Inspected, U = Used | | | | | |
| 671A | ..Pump Shaft, (20 Spline) | 1 | .80-81 | .64671A | .8643768 |
| 671A | ..Pump Shaft, (15 Spline) Conversion | 1 | .80-81 | .64671AA | |
| 671A | ..Pump Shaft, (15 Spline) (w/ Thick Steel Race on Shaft) | 1 | .82-E84 | .64671B | .8643627 |
| 671A | ..Pump Shaft, (15 Spline) (w/ Thin Steel Race on Shaft) | 1 | .L84-Up | .64671C | .8652125 |
| 673F | ..Turbine Shaft | 1 | .80-81 | .64673 | .8631207 |
| 673F | ..Turbine Shaft | 1 | .82-Up | .64673A | .8652382 |
| 674D | ..Shaft, Intermediate Sun Gear Shaft (Final Drive) | 1 | .80-Up | .64674 | .8652388 |
| 678J | ..Output Shaft | 1 | .80-Up | .64678 | .8631640 |

3T40, 125, 125C

Fwd 3 Speed

GM 3T40, 125

| ILL # | Description | Qty | Year | Part # | Reference |
|---|---|-----|---------|----------|-----------|
| Governors | | | | | |
|Prefix Key: AR = Reman, D = Dealer, A = New Aftermarket, Q = Quality Inspected, U = Used | | | | | |
| 680E | ...Governor | 1 | 80-Up | 64680 | 8631931 |
| 680E | ...Governor, Electronic (8 T on Pickup) | 1 | 82-Up | 64680C | |
| 680E | ...Governor, Electronic (13 T on Pickup) | 1 | 82-Up | 64680A | 8652927 |
| 680E | ...Governor, Electronic (14 T on Pickup) | 1 | 82-Up | 64680B | 8637949 |
| 683J | ...Gear, Governor Drive | 1 | 80-Up | 64683A | 8631571 |
| 686E | ...Cover, Governor (Washer Type) | 1 | 80-Up | 64686 | 8632985 |
| 686E | ...Cover, Governor (Bearing Type) | 1 | 80-Up | 64686A | 8652919 |
| 686E | ...Cover, Governor (Bearing Type w/ Needles) | 1 | 80-Up | 64686B | 8652920 |
| Chains | | | | | |
| 700F | ...Chain, 3/4" Wide, 42 Links | 1 | 80-83 | 64700 | 8643337 |
| 700F | ...Chain, 7/8" Wide, 42 Links | 1 | 84-Up | 84700A | 8660099 |
| 701 | ...Chain Snubber | 1 | 80-Up | 64701 | |
| 705F | ...Sprocket, Drive (33 Teeth, 3/4" Chain) | 1 | 80-83 | 64705 | 8631197 |
| 705F | ...Sprocket, Drive (33 Teeth, 7/8" Chain) | 1 | 84-Up | 64705C | 8643209 |
| 705F | ...Sprocket, Drive (35 Teeth, 3/4" Chain) | 1 | 80-83 | 64705D | 8631740 |
| 705F | ...Sprocket, Drive (35 Teeth, 7/8" Chain) | 1 | 84-Up | 64705E | 8643210 |
| 705F | ...Sprocket, Drive (37 Teeth, 3/4" Chain) | 1 | 80-83 | 64705F | 8631741 |
| 705F | ...Sprocket, Drive (37 Teeth, 7/8" Chain) | 1 | 84-Up | 64705G | 8643211 |
| 705F | ...Sprocket, Drive (38 Teeth, 3/4" Chain) | 1 | 80-83 | 64705A | 8637172 |
| 705F | ...Sprocket, Drive (38 Teeth, 7/8" Chain) | 1 | 84-Up | 64705B | 8643212 |
| 706G | ...Sprocket, Driven (32 Teeth, 3/4" Chain) | 1 | 80-83 | 64706D | 8643444 |
| 706G | ...Sprocket, Driven (32 Teeth, 7/8" Chain) | 1 | 84-Up | 64706E | 8643221 |
| 706G | ...Sprocket, Driven (33 Teeth, 3/4" Chain) | 1 | 80-83 | 64706F | 8643445 |
| 706G | ...Sprocket, Driven (33 Teeth, 7/8" Chain) | 1 | 84-Up | 64706G | 8643222 |
| 706G | ...Sprocket, Driven (35 Teeth, 3/4" Chain) | 1 | 80-83 | 64706 | 8643446 |
| 706G | ...Sprocket, Driven (35 Teeth, 7/8" Chain) | 1 | 84-Up | 64706A | 8643223 |
| 706G | ...Sprocket, Driven (37 Teeth, 3/4" Chain) | 1 | 80-83 | 64706B | 8643447 |
| 706G | ...Sprocket, Driven (37 Teeth, 7/8" Chain) | 1 | 84-Up | 64706C | 8643224 |
| 713G | ...Support, Driven Sprocket | 1 | 80-81 | 64713 | 8631954 |
| 713G | ...Support, Driven Sprocket | 1 | 82-84 | 64713A | 8637224 |
| 713G | ...Support, Driven Sprocket | 1 | 85-Up | 64713B | 24205838 |
| Differentials | | | | | |
|Prefix Key: AR = Reman, D = Dealer, A = New Aftermarket, Q = Quality Inspected, U = Used | | | | | |
| 715J | ...Differential, 30 T Sun Gear, 20 T Pinion (.705" OD Cross Pin) 3.33 Ratio | 1 | 80-Up | 64715D | 8643963 |
| 715J | ...Differential, 30 T Sun Gear, 20 T Pinion (.760" OD Cross Pin) 3.33 Ratio | 1 | 80-Up | 84715CA | |
| 715J | ...Differential, 34 T Sun Gear, 18 T Pinion (.705" OD Cross Pin) 3.06 Ratio | 1 | 80-Up | 64715C | 8643990 |
| 715J | ...Differential, 34 T Sun Gear, 18 T Pinion (.760" OD Cross Pin) 3.06 Ratio | 1 | 80-Up | 84715CB | |
| 715J | ...Differential, 38 T Sun Gear, 16 T Pinion (.705" OD Cross Pin) 2.84 Ratio | 1 | 80-Up | 64715 | 8653941 |
| 715J | ...Differential, 38 T Sun Gear, 16 T Pinion (.760" OD Cross Pin) 2.84 Ratio | 1 | 80-Up | 84715AB | |
| 717 | ...Differential Side Gear Assembly | 1 | 80-Up | 64717-6K | 8646919 |
| Valve Bodies | | | | | |
|Prefix Key: AR = Reman, D = Dealer, A = New Aftermarket, Q = Quality Inspected, U = Used | | | | | |
| 740A | ...Pump, w/ Valve Body (w/o Tube) | 1 | 80-81 | 64500 | |
| 740A | ...Pump, w/ Valve Body (w/ Tube) | 1 | 80-81 | 64500A | |
| 740A | ...Pump, w/ Valve Body | 1 | 82-84 | 64500B | |
| 740A | ...Pump, w/ Valve Body (1 Solenoid & 1 Switch) (Square 2 Wire Connector) | 1 | 85-Up | 64500C | |
| 740A | ...Pump, w/ Valve Body (1 Solenoid & 2 Switches) (Round 4 Wire Connector) | 1 | 87-Up | 64500D | |
| 740A | ...Pump, w/ Valve Body (1 Solenoid & 2 Switches) (Square 3 Wire Connector) | 1 | 87-Up | 64500DB | |
| 740A | ...Pump, w/ Valve Body (1 Solenoid & 2 Switches) (Square 4 Wire Connector) | 1 | 87-Up | 64500DA | 24200514 |
| (D, DA, DB Will Interchange If The Original Solenoid Wiring is Used) | | | | | |
| 744 | ...Auxiliary Valve Body | 1 | 82-89 | 64744 | |
| 744 | ...Auxiliary Valve Body | 1 | 90-Up | 64744A | |
| 745A | ...Cover, Valve Body | 1 | 80-81 | 64745B | 8631938 |
| 745A | ...Cover, Valve Body | 1 | 82-84 | 64745 | |
| 745A | ...Cover, Valve Body | 1 | 85-Up | 64745A | 8643645 |
| 747A | ...Plate, Valve Body Separator (Included in T64165) | 1 | 80-Up | 64747 | 8643044 |
| 209A | ...Bearing, Pump Shaft w/o Seal | 1 | 80-5/84 | 64209 | 8631277 |

| ILL # | Description | Qty | Year | Part # | Reference |
|--|---|-----|---------|----------------|------------------|
| Valve Bodies | | | | | |
| 209A | . . . Bearing, Pump Shaft w/ Seal | 1 | 6/84-Up | . . . 64209A |8666375 |
| 538A | . . . Ring, Pump Rotor to Vanes | 2 | .80-Up | . . . 64538 |8631279 |
| 741 | . . . Pin, Boost Valve Retainer (Solid Hardened) | 1 | .80-Up | . . . 64741T-4 | |
| 741 | . . . Plug, Auxiliary Valve Body | 1 | .82-Up | . . . 64741E-6 |8625546 |
| 741 | . . . Plug, Manual Valve | 1 | .80-Up | . . . 64741M-6 |8631165 |
| 741 | . . . Spring, Lock-Up | 1 | .82-Up | . . . 64741C-3 |8637888 |
| 741 | . . . TV & Rev. Boost Valve Kit, (125C) (Reduces Delayed Reverse) (Sonnax) | 1 | .80-Up | . . . S64741RK |75918-01K |
| 741 | . . . Valve, Anti-Drain Back | 1 | .80-Up | . . . 64741A | |
| 741 | . . . Valve & Spring, Anti-Drain Back Valve | 1 | .80-Up | . . . 64741AK | |
| 741 | . . . Valve Kit, 2-3 Shift, w/ Spring | 1 | .80-Up | . . . 64741SK | |
| 741 | . . . Valve, 2-3 Shift | 1 | .80-Up | . . . 64741S-1 | |
| 741 | . . . Valve, Manual Valve Replacement Package | 1 | .80-Up | . . . 64741M-1 |8666494 |
| Cases & Housings | | | | | |
| Prefix Key: AR = Reman, D = Dealer, A = New Aftermarket, Q = Quality Inspected, U = Used | | | | | |
| 755F | . . . Case Cover, (125) | 1 | .80-81 | . . . 64755 |8631996 |
| 755F | . . . Case Cover, (1 Bolt Cable) (w/ Flat Boss) | 1 | .82-Up | . . . 64755A |8631997 |
| 755F | . . . Case Cover, (1 Bolt Cable) (w/ 45 Degree Angle Boss) | 1 | .82-Up | . . . 64755C | |
| 755F | . . . Case Cover, (2 Bolt Cable) (w/ Flat Boss) | 1 | .82-Up | . . . 64755B | |
| 755F | . . . Case Cover, (2 Bolt Cable) (w/ 45 Degree Angle Boss) | 1 | .82-Up | . . . 64755D | |
| Boss is 2" to The Right of The Axle Seal (w/ 1 Threaded Hole) | | | | | |
| 755F | . . . Sleeve, Channel Plate Sleeve | 1 | .80-Up | . . . 64755S | |
| 760E | . . . Case, Flat Top Bell, (125) | 1 | .80-81 | . . . 64760 |8631974 |
| 760E | . . . Case, Flat Top Bell (No Neutral Safety Mounting Holes) Starter is at 4:00 | 1 | .80-Up | . . . 64760A |8653917 |
| 760E | . . . Case, Flat Top Bell (w/ Neutral Safety Mounting Holes) Starter is at 4:00 | 1 | .80-Up | . . . 64760B | |
| 760E | . . . Case, Round Bell (No Neutral Mounting Holes) Starter is at 1:00 | 1 | .80-Up | . . . 64760E | |
| 760E | . . . Case, Round Bell (w/ Neutral Mounting Holes) Starter is at 1:00 | 1 | .80-Up | . . . 64760F | |
| 760E | . . . Case, Round Bell (No Neutral Mounting Holes) Starter is at 10:00 | 1 | .80-Up | . . . 64760C |8631975 |
| 760E | . . . Case, Round Bell (w/ Neutral Mounting Holes) Starter is at 10:00 | 1 | .80-Up | . . . 64760D |8653918 |
| Starter Location is While Looking Into The Bell | | | | | |
| 916 | . . . Band, Anchor Plug (Plastic) | 1 | .80-Up | . . . 64916-5 |8637640 |
| 090 | . . . Axle Stabilizer, Passenger Side (Bushing Type) | 1 | .80-Up | . . . 64090 | |
| 275 | . . . Axle Stabilizer, Both Sides (Bearing Type) (Teckpak) | 1 | .80-Up | . . . T64275 |75125LRB |
| 698E | . . . Oil Weir Kit | 1 | .80-Up | . . . 64698A |8637836 |
| 701 | . . . Chain Snubber | 1 | .80-Up | . . . 64701 | |
| 761 | . . . Nail, Holds Manual Shaft in Case | 1 | .80-Up | . . . 64761-4 |8631532 |
| 765J | . . . Pan, Bottom | 1 | .80-83 | . . . 64765 |8653942 |
| 765J | . . . Pan, Bottom | 1 | .84-Up | . . . 64765A |8643574 |
| 766A | . . . Pan, Side | 1 | .80-81 | . . . 64766 | |
| 766A | . . . Pan, Side | 1 | .80-83 | . . . 64766A |8653943 |
| 766A | . . . Pan, Side | 1 | .84-Up | . . . 64766B |8643575 |
| 774E | . . . Housing, Driven Speed-O-Gear (Bullet) | 1 | .80-Up | . . . 64774 |25519848 |
| 774E | . . . Housing Kit, 29 T Green Driven Speed-O-Gear, Shaft & Housing | 1 | .80-Up | . . . 84774C |25524924 |
| 775 | . . . Bolt, GM Torque Converter Low Profile Metric 8.8mm | 3 | .80-Up | . . . 64775 | |
| 842 | . . . Clip, Holds Speed-O-Housing to Cover | 1 | .80-Up | . . . 64842 |3708148 |
| 847E | . . . Pick-Up Wheel, (Reluctor) 8 Teeth | 1 | .82-Up | . . . 64847P |8666642 |
| 847E | . . . Pick-Up Wheel, (Reluctor) 11 Teeth | 1 | .82-Up | . . . 64847PA |8666643 |
| 847E | . . . Pick-Up Wheel, (Reluctor) 14 Teeth | 1 | .82-Up | . . . 64847PB |8666644 |
| 847E | . . . Gear, Speed-O Drive (See Chart) | 1 | .80-Up | . . . 64847 |8632646 |
| 848E | . . . Gear, Speed-O Driven (See Chart) | 1 | .80-Up | . . . 64848 | |
| Snap Rings | | | | | |
| Prefix Key: AR = Reman, D = Dealer, A = New Aftermarket, Q = Quality Inspected, U = Used | | | | | |
| 874J | . . . Holds Pinion Pins to Differential Housing (Spiral) (Superior) | 1 | .80-Up | . . . 76874A |11501326 |
| 876H | . . . Holds Forward/ Direct Clutch Pressure Plate In Drum | 3 | .80-Up | . . . 64876 |8652055 |
| 877H | . . . Holds Forward Clutch Spring Retainer In Drum | 1 | .80-Up | . . . 64877 |8631948 |
| 878B | . . . Holds Direct Clutch Pressure Plate In Drum | 1 | .80-Up | . . . 64876 |8652055 |
| 879B | . . . Holds Direct Clutch Retainer In Drum | 1 | .80-Up | . . . 64876 |8652055 |
| 880 | . . . Holds Drive Sprocket to Turbine Shaft | 1 | .80-Up | . . . 64880 |8631210 |
| 883C | . . . Holds Low/ Reverse Clutch Housing In Case | 1 | .80-Up | . . . 64883 |8631078 |
| 884I | . . . Holds Low/ Reverse Clutch Housing Retainer In (Spiral) (Superior) | 1 | .80-Up | . . . 64884A |8631948 |

3T40, 125, 125C

Fwd 3 Speed

GM 3T40, 125

| ILL # | Description | Qty | Year | Part # | Reference |
|---------------------------------|--|-----|---------|-----------|-----------|
| Snap Rings | | | | | |
| 885I | ...Holds Low/ Reverse Clutches In Case | 1 | 80-Up | .64885 | .8631549 |
| 886C | ...Holds Input Shell to Sun Gear (.091" Thick) | 1 | 80-Up | .64886AA | .8631602 |
| 886C | ...Holds Input Shell to Sun Gear (.098" Thick) | 1 | 80-Up | .64886AB | .8631603 |
| 886C | ...Holds Input Shell to Sun Gear (.106" Thick) | 1 | 80-Up | .64886AC | .8631604 |
| 886C | ...Holds Input Shell to Sun Gear (.111" Thick) | 1 | 80-Up | .64886AD | .8631605 |
| 886C | ...Holds Input Shell to Sun Gear (.118" Thick) | 1 | 80-Up | .64886AE | .8631606 |
| 886C | ...Holds Input Shell to Sun Gear (.125" Thick) | 1 | 80-Up | .64886AF | .8631607 |
| 886C | ...Holds Input Shell to Sun Gear (.132" Thick) | 1 | 80-Up | .64886AG | .8631608 |
| 886C | ...Holds Input Shell to Sun Gear (.138" Thick) | 1 | 80-Up | .64886AH | .8631609 |
| 888 | ...Holds Pinion Pins to Differential Housing (Spiral) | 1 | 80-Up | .76874A | .11501326 |
| 887J | ...Holds Output Shaft to Differential | 2 | 80-Up | .64887 | .8631948 |
| 895 | ...Output Shaft to Left Axle | 1 | 80-Up | .64895 | .7829495 |
| 890D | ...Holds Final Drive Ring Gear In Case | 1 | 80-Up | .64883 | .8631078 |
| 899H | ...Forward Drum Shaft to Driven Sprocket Support (1.83-1.93mm) | 1 | 80-Up | .64899AA | .8631258 |
| 899H | ...Forward Drum Shaft to Driven Sprocket Support (2.03-2.13mm) | 1 | 80-Up | .64899AB | .8631259 |
| 899H | ...Forward Drum Shaft to Driven Sprocket Support (2.23-2.33mm) | 1 | 80-Up | .64899AC | .8631260 |
| 899H | ...Forward Drum Shaft to Driven Sprocket Support (2.43-2.53mm) | 1 | 80-Up | .64899AD | .8631261 |
| 899H | ...Forward Drum Shaft to Driven Sprocket Support (2.63-2.73mm) | 1 | 80-Up | .64899AE | .8631262 |
| Miscellaneous Components | | | | | |
| 905E | ...Servo Assembly, Intermediate (1.260" ID) | 1 | 80-Up | .64905 | |
| 905E | ...Servo Assembly, Intermediate (1.495" ID) | 1 | 80-Up | .64905A | .8652901 |
| 905E | ...Servo Assembly, Intermediate (1.672" ID) | 1 | 80-Up | .64905B | |
| 906E | ...Spring, Intermediate Servo Cushion | 1 | 80-Up | .64906 | .8652057 |
| 906E | ...Spring, Intermediate Servo Cushion (Red) | 1 | 80-Up | .64906A | .8631463 |
| 907E | ...Piston, Intermediate Servo | 1 | 80-Up | .64907 | .8652900 |
| 908E | ...Pin, Intermediate Servo (No Groove) | 1 | 80-Up | .64908 | .8631923 |
| 908E | ...Pin, Intermediate Servo (1 Groove) | 1 | 80-Up | .64908A | .8631924 |
| 908E | ...Pin, Intermediate Servo (2 Groove) | 1 | 80-Up | .64908B | .8631925 |
| 909E | ...Cover, Intermediate Servo (1.260" ID) | 1 | 80-Up | .64909 | .8631702 |
| 909E | ...Cover, Intermediate Servo (1.495" ID) | 1 | 80-Up | .64909A | .8631703 |
| 909E | ...Cover, Intermediate Servo (1.672" ID) | 1 | 80-Up | .64909B | .8631704 |
| 916 | ...Anchor Plug, Band | 1 | 80-Up | .64916-5 | .8637640 |
| 925G | ...Accumulator Assembly, 1-2 Accumulator | 1 | 80-Up | .64925C | |
| 926G | ...Spring, 1-2 Accumulator (Purple) | 1 | 80-E85 | .64926 | .8631168 |
| 926G | ...Spring, 1-2 Accumulator (Purple) Has Thicker Coils Than 64926 | 1 | .L85-Up | .64926A | .8652501 |
| 927 | ...Piston, 1-2 Accumulator | 1 | 80-Up | .64927 | .8665920 |
| 928 | ...Pin, 1-2 Accumulator | 1 | 80-Up | .64928 | .8665840 |
| 952E | ...Valve, 2-3 Shift (Accumulator) | 1 | 80-Up | .64741S-1 | .8643964 |
| 952E | ...Valve & Spring Kit, 2-3 Shift Fix (Accumulator) | 1 | 80-Up | .64741SK | .8643964 |
| 958D | ...Spacer, Final Drive (Tin) | 1 | 80-Up | .64958 | .8652022 |
| 963H | ...Insert, Under Forward Piston | 1 | 80-Up | .64963 | .8643606 |
| 964H | ...Piston, Forward Clutch | 1 | 80-Up | .64964 | .8637973 |
| 964H | ...Spacer Ring, Under Forward Clutch Piston | 1 | 80-86 | .64964B | .8643606 |
| 964H | ...Spacer Ring, Under Forward Clutch Piston | 1 | 87-Up | .64964BA | .24200183 |
| 965B | ...Piston, Direct Clutch | 1 | 80-Up | .64965 | .8631009 |
| 967I | ...Piston, w/ Insert, Low/ Reverse Clutch | 1 | 80-Up | .64967 | .8652024 |
| 974H | ...Spring, Forward Clutch Return | 1 | 80-Up | .64974 | |
| 975B | ...Spring w/ Retainer, Direct Clutch | 1 | 80-Up | .64975 | .8664636 |
| 977I | ...Return Spring, Low/ Reverse Clutch (Waved) | 1 | 80-Up | .54977A | .8628222 |
| 977I | ...Return Spring, Low/ Reverse Clutch (Diaphragm) (1993 Update) | 1 | 80-Up | .64977 | .8683616 |
| 987I | ...Retainer, Low/ Reverse Clutch | 1 | 80-Up | .64987 | .8631075 |
| 991G | ...Shaft, Manual | 1 | 80-Up | .64991 | .8637970 |
| 993F | ...Linkage Assembly, Internal | 1 | 80-Up | .64993 | .8682973 |
| 995E | ...Park Pawl Assembly, w/ Park Rod | 1 | 80-Up | .64995 | |
| 997A | ...T.V. Bracket | 1 | 80-Up | .64997 | .8631685 |
| 999E | ...Tube Set | 1 | 80-Up | .64999 | .8664493 |